

# OLYMPIC BOULEVARD IMPROVEMENTS PROJECT



URBAN FOREST TASK FORCE  
Wednesday, May 23, 2018

# **URBAN FOREST TASK FORCE**

Wednesday, May 23, 2018

## **Olympic Blvd. Improvements Discussion**

### **1. Overview**

- Goal + Objectives
- Project Location

### **2. Opportunities/Considerations**

- Adjacent Pen Factory (private)
- City right-of-way (public)
- Tree Retention Categories
- Preliminary Tree Valuations

### **3. Draft Proposed Plan (Work in Progress)**

### **4. Next Steps**

## GOAL:

Implement Connectivity and Safety Improvements to the Expo 26<sup>th</sup> Street/Bergamot Station and Expo Corridor Bike/Pedestrian Path

## OBJECTIVES:

- Improve east leg crossing at 26<sup>th</sup> St./Olympic Blvd. intersection
- Install new sidewalk and pedestrian/street lighting on Olympic Blvd.



INTERSECTION OF 26<sup>TH</sup> ST./OLYMPIC BLVD., LOOKING NORTH



OLYMPIC BLVD. EAST OF 26<sup>TH</sup> ST., LOOKING EAST

# PROJECT LOCATION



EXPO STATION + PED/BIKE PATH



BIG BLUE BUS



BERGAMOT PLAN AREA

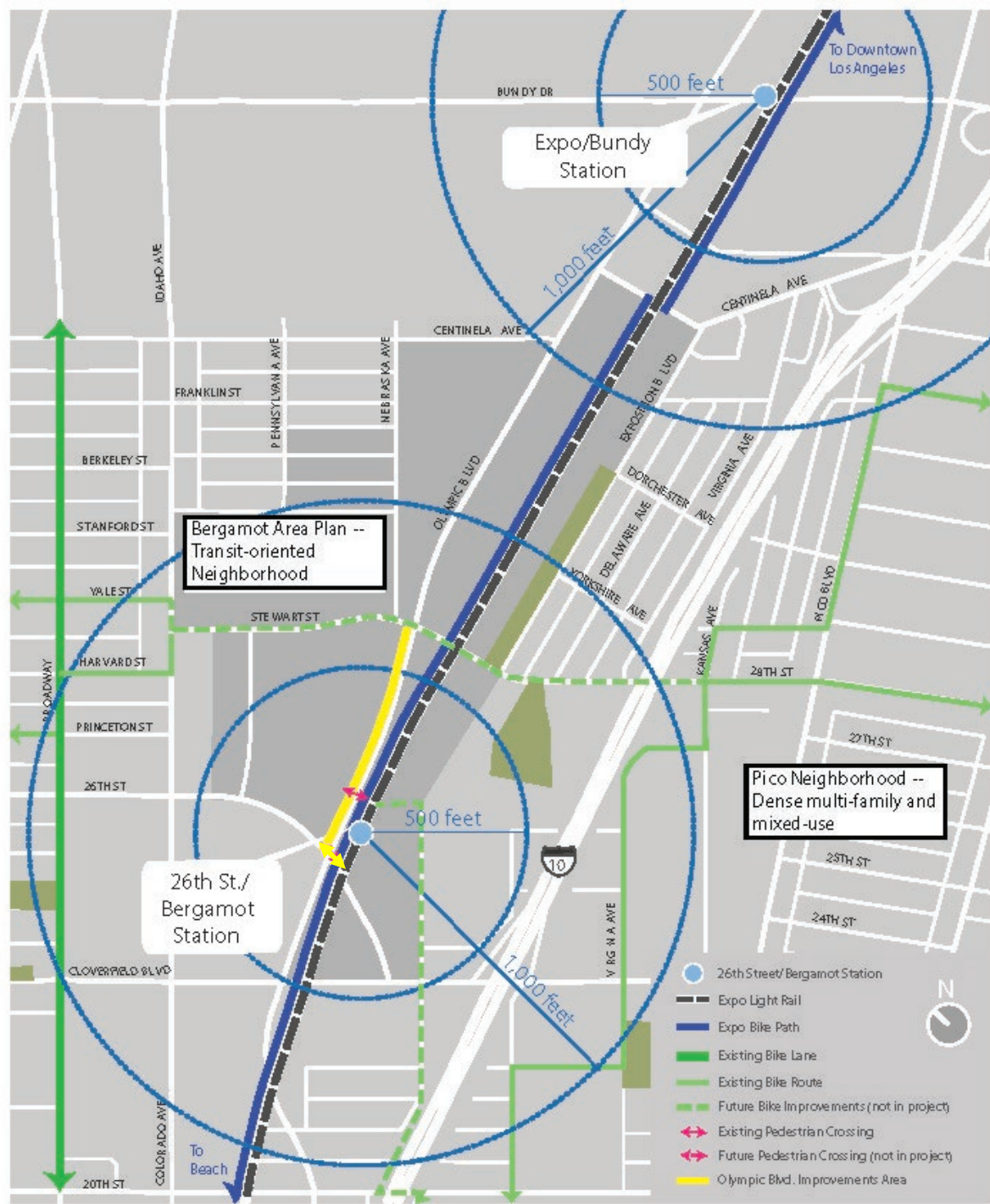

# PROJECT LOCATION



- Expo Station and Light Rail
- Expo Corridor Bike/Ped Path
- Bus Stop
- Project Area

Improvements By Others:

- Stewart Street and Pennsylvania Avenue Improvements Project
- Future Pedestrian Crossing

# PEN FACTORY...

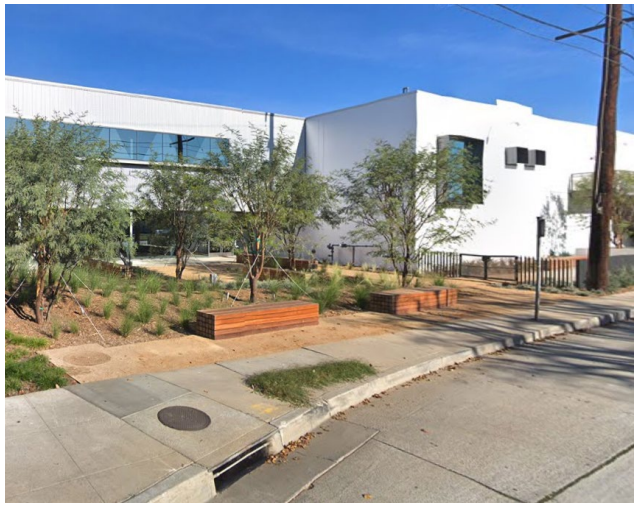
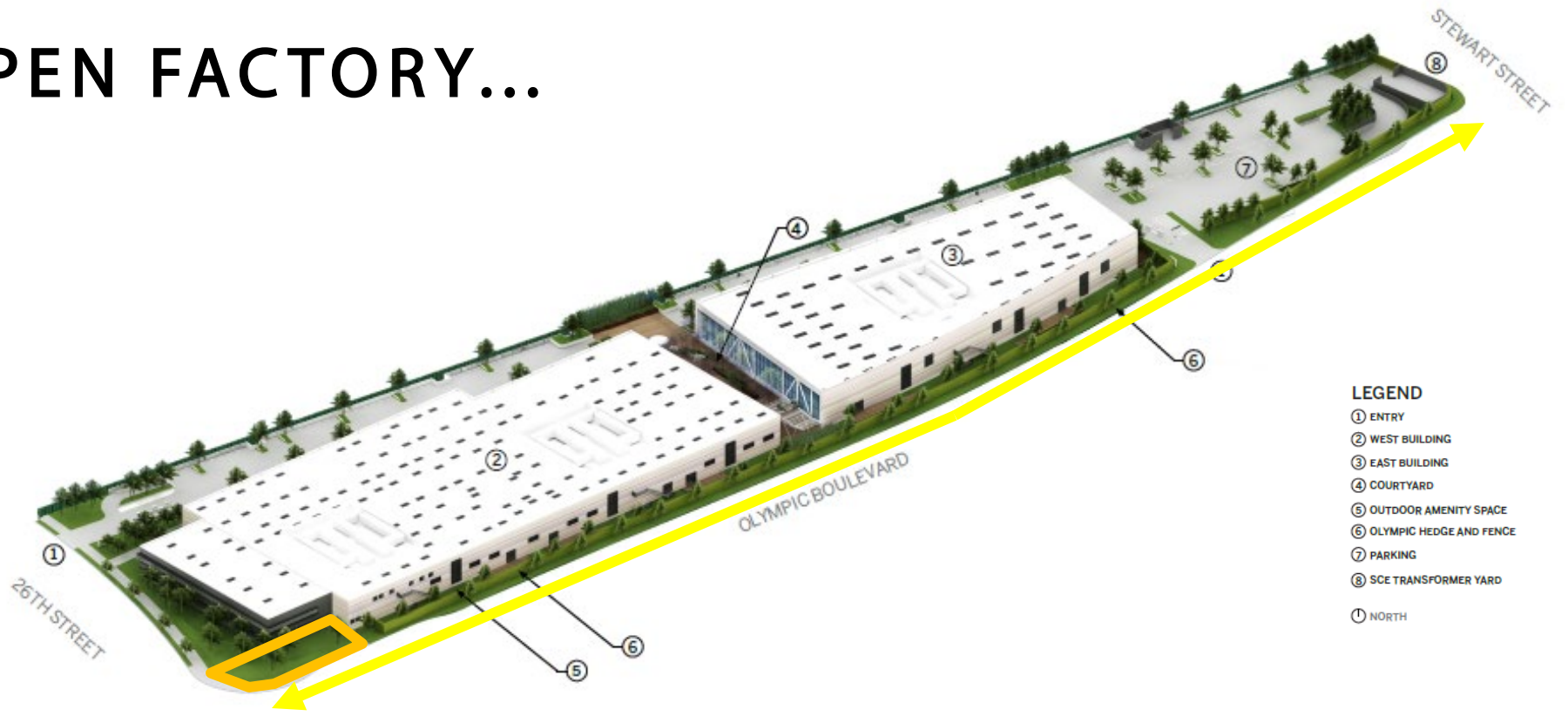

OUTDOOR SPACE

# PEN FACTORY...

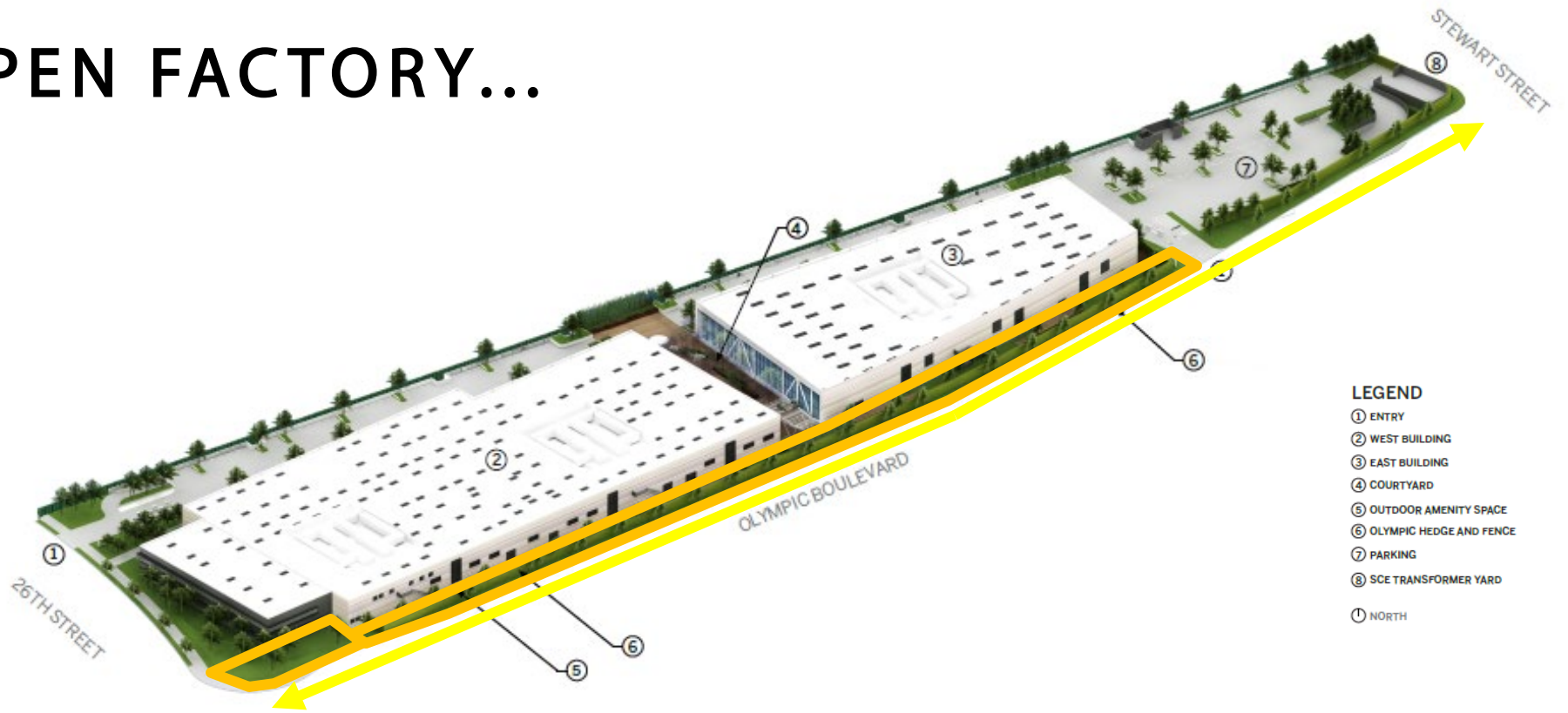

## LEGEND

- ① ENTRY
- ② WEST BUILDING
- ③ EAST BUILDING
- ④ COURTYARD
- ⑤ OUTDOOR AMENITY SPACE
- ⑥ OLYMPIC HEDGE AND FENCE
- ⑦ PARKING
- ⑧ SCE TRANSFORMER YARD
- ⌚ NORTH

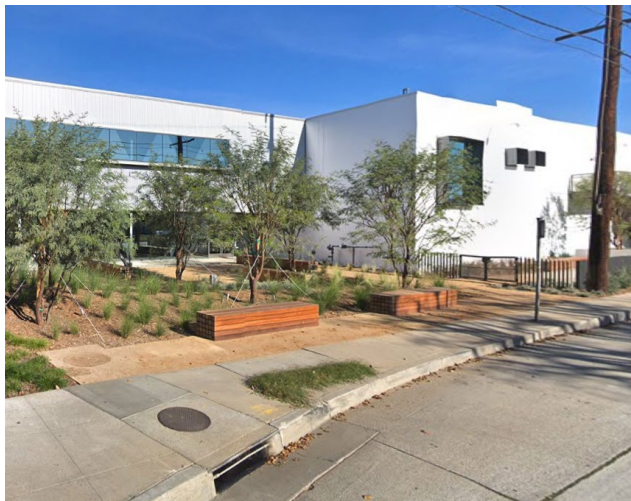

OUTDOOR SPACE



OUTDOOR DECKS + WALL/FENCE

# PEN FACTORY...

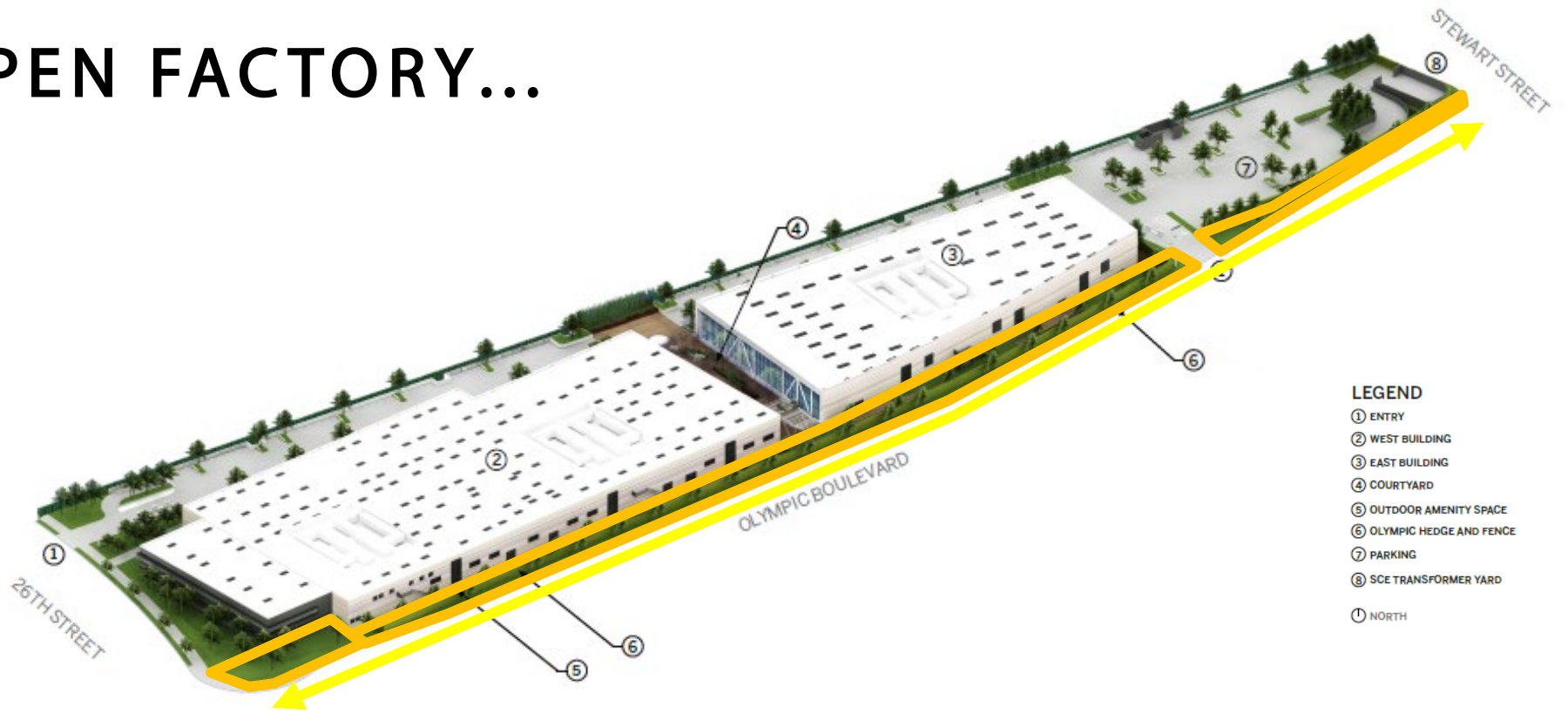

- LEGEND**
- ① ENTRY
  - ② WEST BUILDING
  - ③ EAST BUILDING
  - ④ COURTYARD
  - ⑤ OUTDOOR AMENITY SPACE
  - ⑥ OLYMPIC HEDGE AND FENCE
  - ⑦ PARKING
  - ⑧ SCE TRANSFORMER YARD
  - ⬆ NORTH

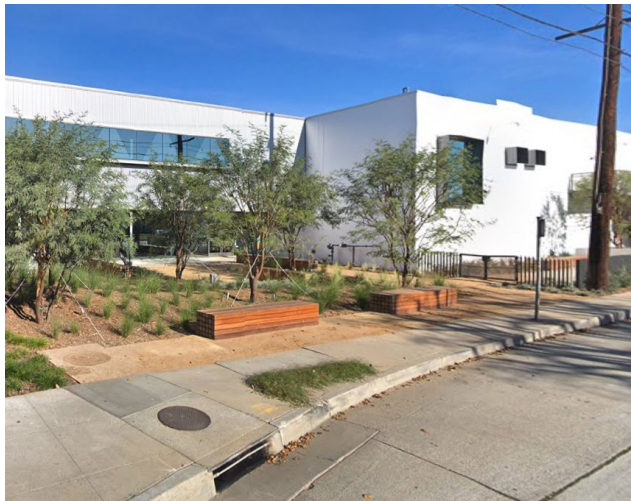

OUTDOOR SPACE



OUTDOOR DECKS + WALL/FENCE



PARKING + HEDGE



**PROJECT OPPORTUNITIES...**



**... AND CONSIDERATIONS**

# OPPORTUNITIES + CONSIDERATIONS

	ADJACENT PEN FACTORY (PRIVATE PROPERTY)
OPPORTUNITIES	<ul style="list-style-type: none"><li>• Partner with Pen Factory*</li></ul> <p>*Requires Pen Factory concurrence, easement, and Architectural Review Board (ARB) approval</p>
CONSIDERATIONS	<ul style="list-style-type: none"><li>• 3'-6" landscaped areas between Pen Factory fence and City right-of-way</li><li>• Parking lot area</li><li>• 6" gap between Pen Factory wall and City right-of-way</li><li>• On-site drainage</li><li>• Power poles</li></ul>



OLYMPIC BLVD. EAST OF 26<sup>TH</sup> ST., LOOKING EAST

# OPPORTUNITIES + CONSIDERATIONS

	CITY RIGHT-OF-WAY (PUBLIC)
OPPORTUNITIES	<ul style="list-style-type: none"><li>• Improve crossing at 26<sup>th</sup>/Olympic intersection</li><li>• New curb and sidewalk</li><li>• New ped/street lighting</li><li>• New trees and irrigation</li></ul>
CONSIDERATIONS	<ul style="list-style-type: none"><li>• Remove right turn slip lane</li><li>• Tighten curb radius</li><li>• Extend median/create pedestrian refuge area</li><li>• Narrow travel lanes</li><li>• Sidewalk options for protecting existing trees</li><li>• Cross-check new trees with Pen Factory site</li><li>• Assess existing trees</li></ul>







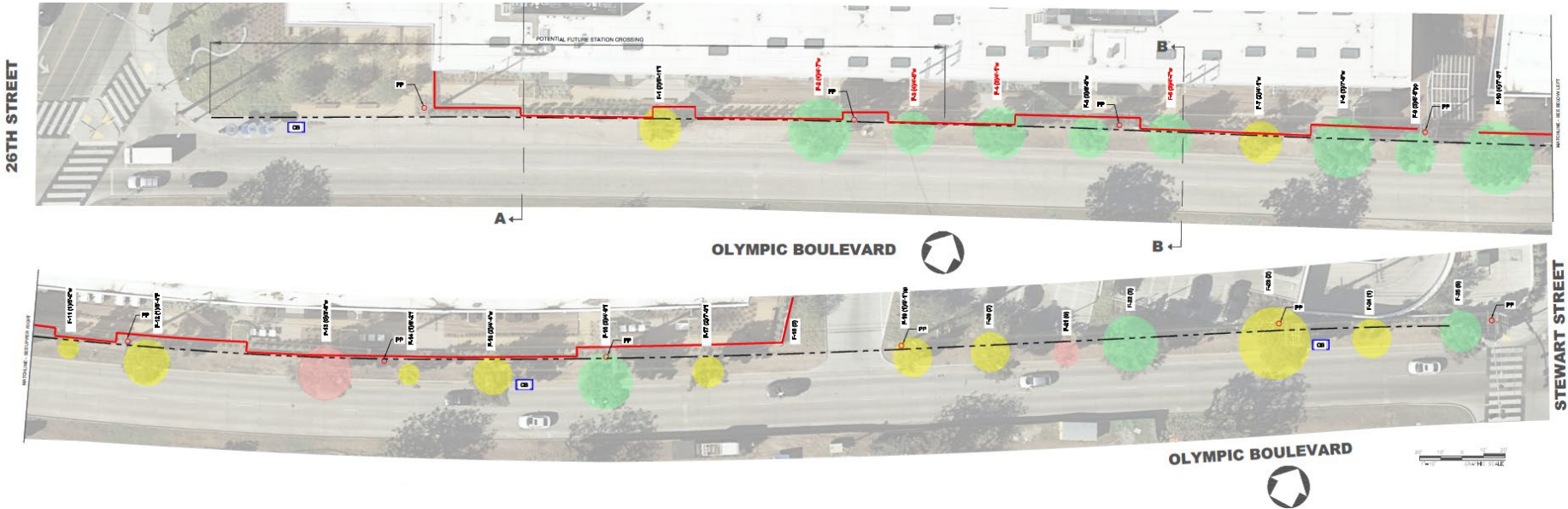

INTERSECTION OF 26<sup>TH</sup> ST./OLYMPIC BLVD., LOOKING SOUTH

# Tree Retention Categories



## LEGEND

1.  $F-X (X)/X'-X''$  = TREE ID (RETENTION CATEGORY) / DISTANCE BETWEEN FENCE (f), WALL (w), OR POWER POLE (pp)
2.  = FENCE/CMU WALL
3.  = EXISTING POWER POLE
4.  = EXISTING TREE - REMOVE (RETENTION CATEGORY 0)
5.  = EXISTING TREE - OKAY TO REMOVE (RETENTION CATEGORY: 1-2)
6.  = EXISTING TREE - KEEP (RETENTION CATEGORY: 3-5)
7.  = EXISTING STORM DRAIN CATCH BASIN
8.  = R/W

# Preliminary Tree Valuations (to be confirmed)

Street	Tree	CommonName	BotanicalName	Replacement Trees
OLYMPIC BL	1	CAJEPUT TREE	Melaleuca quinquenervia	1.2
OLYMPIC BL	2	CAJEPUT TREE	Melaleuca quinquenervia	16.9
OLYMPIC BL	3	CAJEPUT TREE	Melaleuca quinquenervia	7.8
OLYMPIC BL	4	CAJEPUT TREE	Melaleuca quinquenervia	6.1
OLYMPIC BL	5	CAJEPUT TREE	Melaleuca quinquenervia	3.3
OLYMPIC BL	6	CAJEPUT TREE	Melaleuca quinquenervia	6.1
OLYMPIC BL	7	CAJEPUT TREE	Melaleuca quinquenervia	4.4
OLYMPIC BL	8	CAJEPUT TREE	Melaleuca quinquenervia	7.8
OLYMPIC BL	9	CAJEPUT TREE	Melaleuca quinquenervia	3.9
OLYMPIC BL	10	CAJEPUT TREE	Melaleuca quinquenervia	16.9
OLYMPIC BL	11	CAJEPUT TREE	Melaleuca quinquenervia	0.7
OLYMPIC BL	12	CAJEPUT TREE	Melaleuca quinquenervia	2.3
OLYMPIC BL	13	CAJEPUT TREE	Melaleuca quinquenervia	0.0
OLYMPIC BL	14	CAJEPUT TREE	Melaleuca quinquenervia	0.3
OLYMPIC BL	15	CAJEPUT TREE	Melaleuca quinquenervia	3.8
OLYMPIC BL	16	CAJEPUT TREE	Melaleuca quinquenervia	4.6
OLYMPIC BL	17	CAJEPUT TREE	Melaleuca quinquenervia	2.8
OLYMPIC BL	18	CAJEPUT TREE	Melaleuca quinquenervia	0.6
OLYMPIC BL	19	CAJEPUT TREE	Melaleuca quinquenervia	4.4
OLYMPIC BL	20	CAJEPUT TREE	Melaleuca quinquenervia	0.0
OLYMPIC BL	21	CAJEPUT TREE	Melaleuca quinquenervia	13.9
OLYMPIC BL	22	CAJEPUT TREE	Melaleuca quinquenervia	6.1
OLYMPIC BL	23	CAJEPUT TREE	Melaleuca quinquenervia	0.6
OLYMPIC BL	24	CAJEPUT TREE	Melaleuca quinquenervia	5.0
<b>Totals</b>				<b>119.3</b>

# Preliminary Tree Valuations (to be confirmed)

Street	Tree	CommonName	BotanicalName	Replacement Trees
OLYMPIC BL	1	CAJEPUT TREE	Melaleuca quinquenervia	1.2
OLYMPIC BL	2	CAJEPUT TREE	Melaleuca quinquenervia	16.9
OLYMPIC BL	3	CAJEPUT TREE	Melaleuca quinquenervia	7.8
OLYMPIC BL	4	CAJEPUT TREE	Melaleuca quinquenervia	6.1
OLYMPIC BL	5	CAJEPUT TREE	Melaleuca quinquenervia	3.3
OLYMPIC BL	6	CAJEPUT TREE	Melaleuca quinquenervia	6.1
OLYMPIC BL	7	CAJEPUT TREE	Melaleuca quinquenervia	4.4
OLYMPIC BL	8	CAJEPUT TREE	Melaleuca quinquenervia	7.8
OLYMPIC BL	9	CAJEPUT TREE	Melaleuca quinquenervia	3.9
OLYMPIC BL	10	CAJEPUT TREE	Melaleuca quinquenervia	16.9
OLYMPIC BL	11	CAJEPUT TREE	Melaleuca quinquenervia	0.7
OLYMPIC BL	12	CAJEPUT TREE	Melaleuca quinquenervia	2.3
OLYMPIC BL	13	CAJEPUT TREE	Melaleuca quinquenervia	0.0
OLYMPIC BL	14	CAJEPUT TREE	Melaleuca quinquenervia	0.3
OLYMPIC BL	15	CAJEPUT TREE	Melaleuca quinquenervia	3.8
OLYMPIC BL	16	CAJEPUT TREE	Melaleuca quinquenervia	4.6
OLYMPIC BL	17	CAJEPUT TREE	Melaleuca quinquenervia	2.8
OLYMPIC BL	18	CAJEPUT TREE	Melaleuca quinquenervia	0.6
OLYMPIC BL	19	CAJEPUT TREE	Melaleuca quinquenervia	4.4
OLYMPIC BL	20	CAJEPUT TREE	Melaleuca quinquenervia	0.0
OLYMPIC BL	21	CAJEPUT TREE	Melaleuca quinquenervia	13.9
OLYMPIC BL	22	CAJEPUT TREE	Melaleuca quinquenervia	6.1
OLYMPIC BL	23	CAJEPUT TREE	Melaleuca quinquenervia	0.6
OLYMPIC BL	24	CAJEPUT TREE	Melaleuca quinquenervia	5.0
<b>Totals</b>				<b>119.3</b>

\*Remaining 19 trees range between 1-8 replacement trees

# Highest-Value Trees



TREE #2 – 16.9 REPLACEMENT TREES



TREE #10 – 16.9 REPLACEMENT TREES



TREE #21 – 13.9 REPLACEMENT TREES

# PROPOSED PLAN:

**DRAFT**

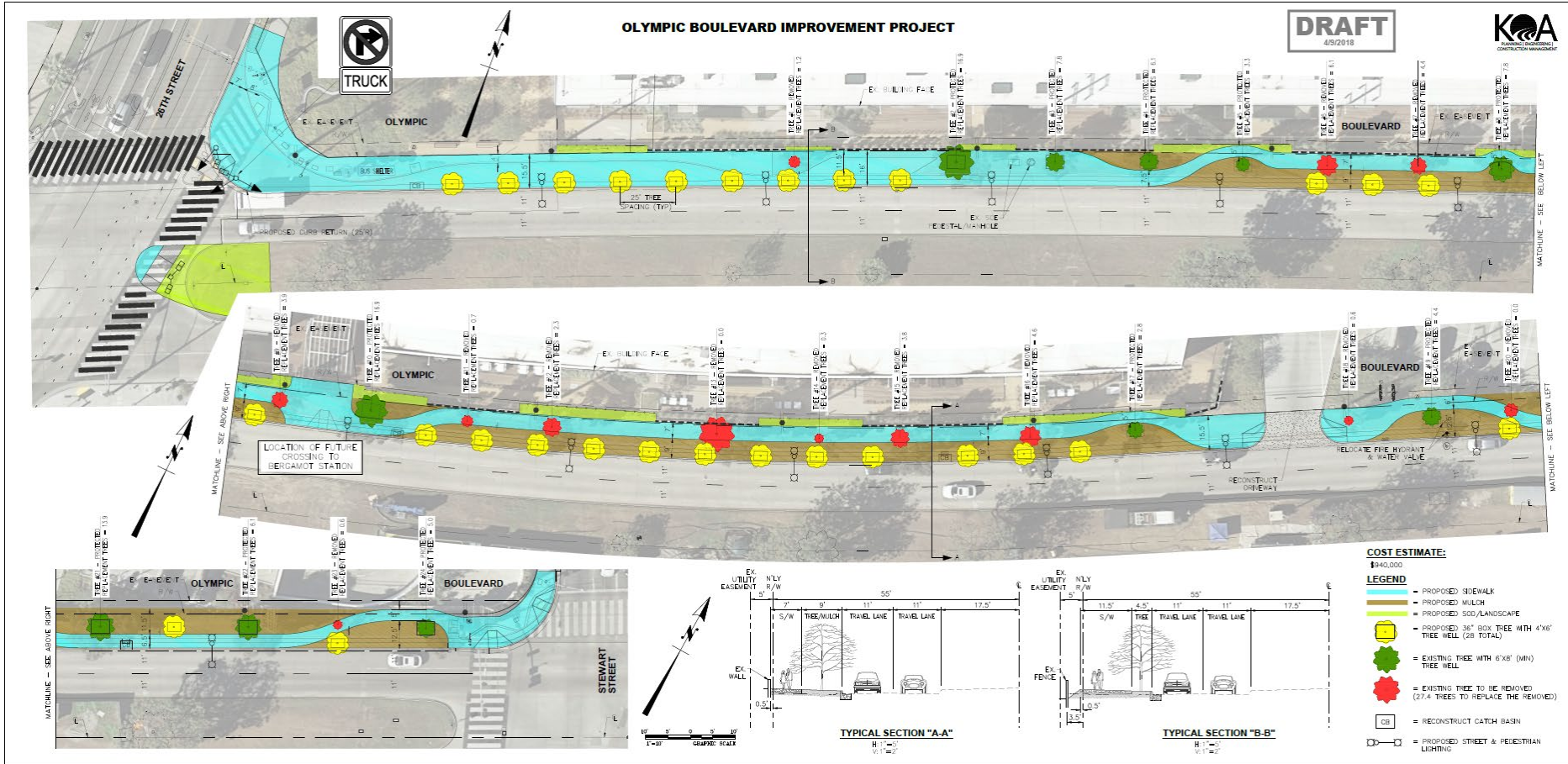



# TREE SUMMARY...

- 13 existing trees to be removed
  - 2 x retention category 0 (remove)
  - 8 x retention category 1-2 (okay to remove)
  - 3 x retention category 3-5 (keep if possible)
- 3 Highest-value trees protected
- Project area able to accept all 28 replacement trees
- New trees to be installed away from overhead wires
- New irrigation and curb protection

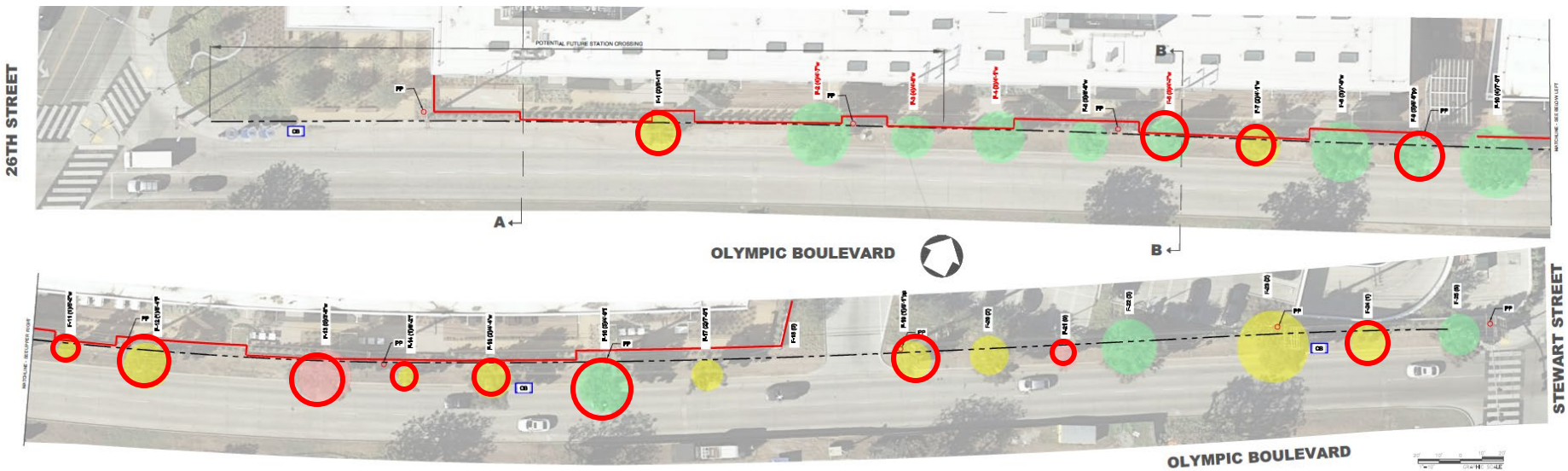

# PROPOSED PLAN:

**DRAFT**

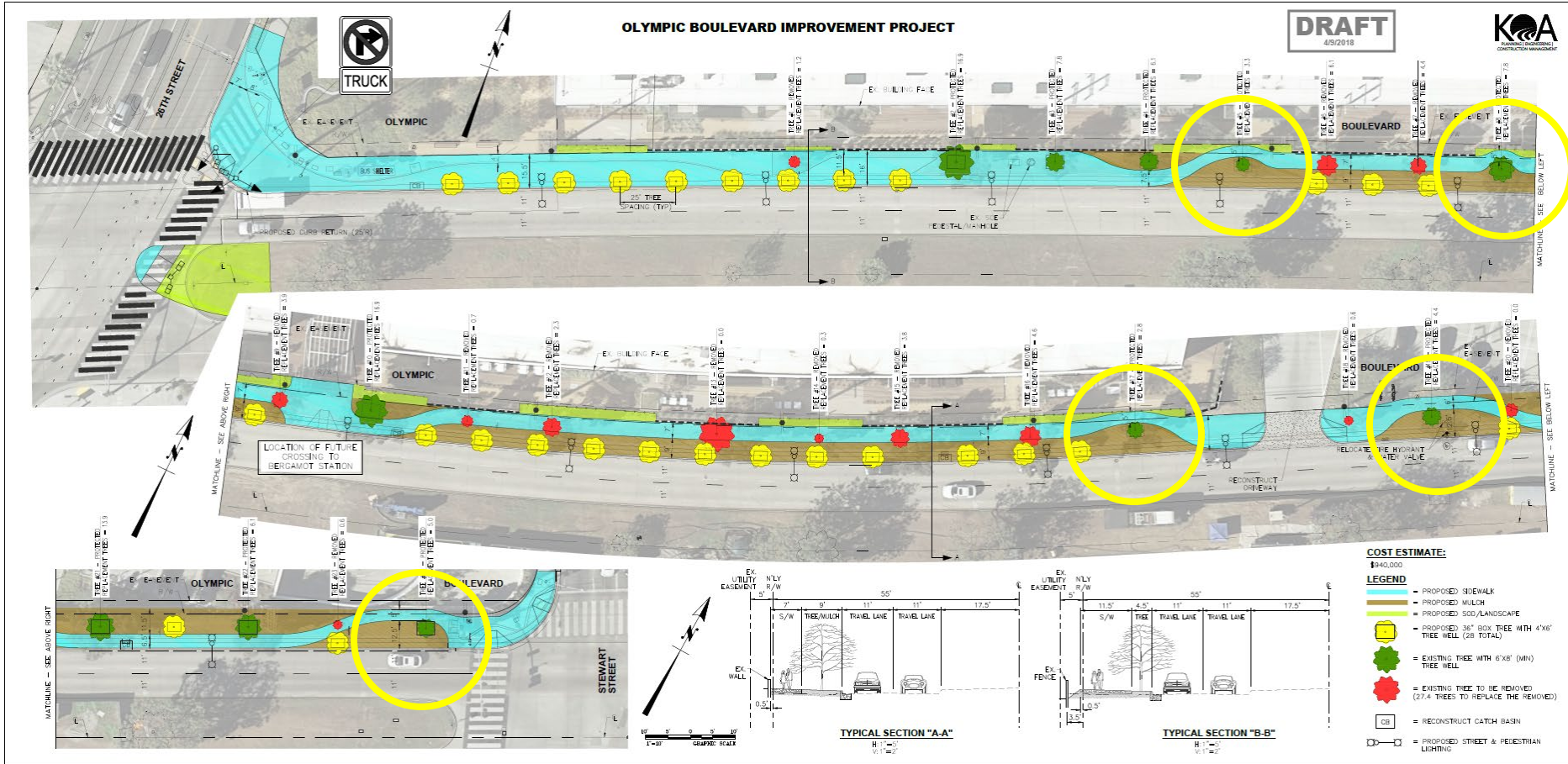

# PROPOSED SIDEWALK:

**DRAFT**



# PROPOSED LIGHTING:



EXISTING STREET LIGHTING



EXISTING PEDESTRIAN LIGHTING



EXAMPLE PIGGY-BACK PEDESTRIAN LIGHTING



EXAMPLE PIGGY-BACK PEDESTRIAN LIGHTING

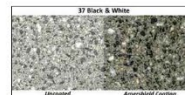
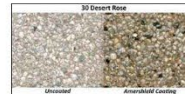

EXAMPLE POWDER COATING

# PROPOSED PED REFUGE: **DRAFT**



INTERSECTION OF 26<sup>TH</sup> ST./SAN VICENTE BLVD., LOOKING NORTH

# NEXT STEPS...

- Pen Factory coordination
- Final Draft Preferred Alternative
  - City/stakeholder input
  - Public outreach
- Refine Preferred Alternative and Final Design
- Funded for Construction Beginning Early 2019

# OLYMPIC BOULEVARD IMPROVEMENTS PROJECT



URBAN FOREST TASK FORCE  
Wednesday, May 23, 2018

# PHOTO SURVEY...



**OLYMPIC BLVD – FULL STREET VIEW**



# PHOTO SURVEY...



**26<sup>th</sup>/OLYMPIC - NORTHEAST CORNER**

# PHOTO SURVEY...



**OLYMPIC BLVD - NORTH SIDE VIEW**

# PHOTO SURVEY...



# OLYMPIC BLVD – SOUTH SIDE VIEWS